

<b>FICHA DE META DADOS – CEDIM 2019/1</b>	
<b>Nome da Pasta</b>	Arquivo de Plantas da Prefeitura da Cidade de Nova Iguaçu
<b>Autor/Instituição</b>	Secretaria Municipal de Infraestrutura- SEMIF/ Subsecretaria de Urbanismo de Nova Iguaçu.
<b>Número de Documentos</b>	2
<b>Quantidade e tipo de documentação</b>	Uma planta de loteamento
<b>Dia/ Mês/Ano</b>	26/12/1952
<b>Série</b>	199/52
<b>Formato</b>	***
<b>Resumo</b>	O acervo contempla tanto plantas residenciais e comerciais, quanto plantas de loteamento na cidade de Nova Iguaçu na primeira metade do século XX. Depositadas junto a Secretaria Municipal de Infraestrutura-SEMIF/Subsecretaria de Urbanismo de Nova Iguaçu, a documentação possui dados como nome do proprietário, logradouro, dimensões do terreno e profissional responsável pela obra. Dentre as plantas já digitalizadas, está o prédio da câmara Municipal, edificada em 1907 sendo posteriormente ocupado pela Prefeitura Municipal até sua demolição em 1964. Loteamento de bairros inteiros como Austin, Vila Anita e Caiçara. A maior parte da documentação



MINISTÉRIO DA EDUCAÇÃO  
UNIVERSIDADE FEDERAL RURAL DO RIO DE JANEIRO  
INSTITUTO MULTIDISCIPLINAR – CAMPUS NOVA IGUAÇU  
CENTRO DE DOCUMENTAÇÃO E IMAGEM



	encontra-se em bom estado mas também pode conter marcas de dobraduras e desgaste pelo manuseio contínuo.
<b>Palavras-Chave</b>	Planta; Nova Iguaçu;
<b>Notas explicativas</b>	***

PREFEITURA MUNICIPAL DE NOVA IGUAÇU



199-52

PROCESSO: \_\_\_\_\_  
REQUERENTE: Miguel Soares  
ASSUNTO: \_\_\_\_\_

ANDAMENTO DO PROCESSO

DESTINO	DATA	DESTINO	DATA

ANEXO: \_\_\_\_\_  
\_\_\_\_\_  
\_\_\_\_\_



RUA RIBEIRA DA CUNHA

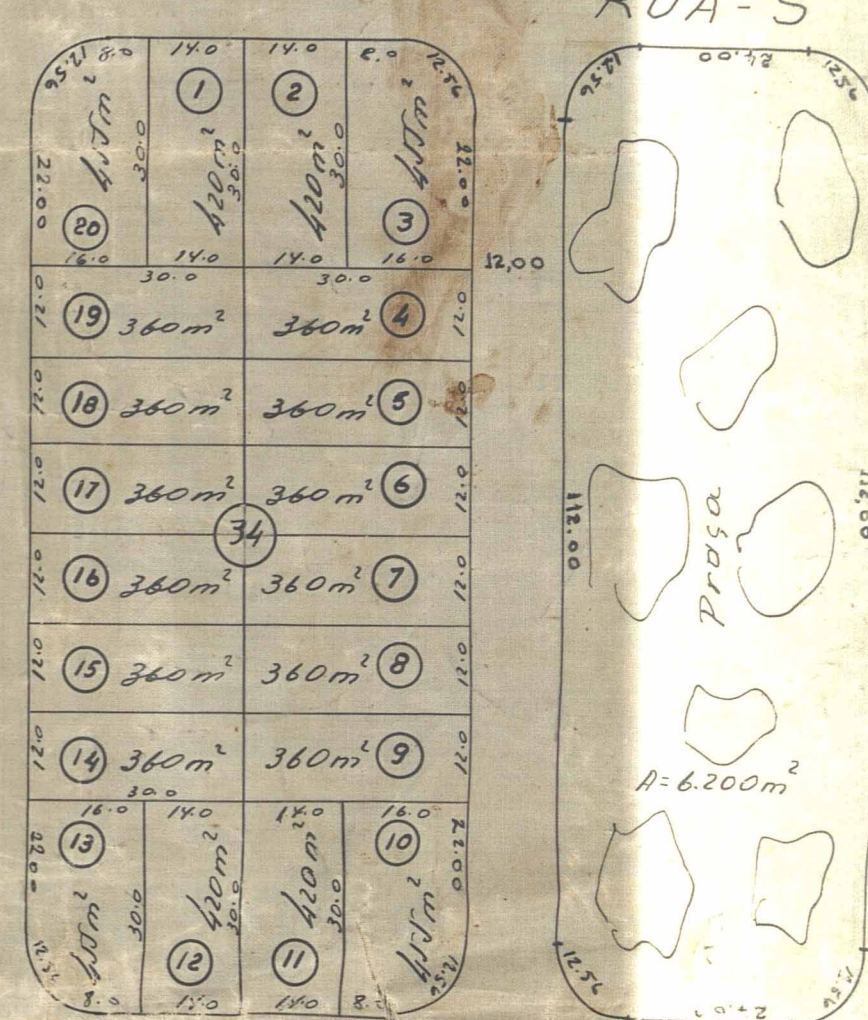
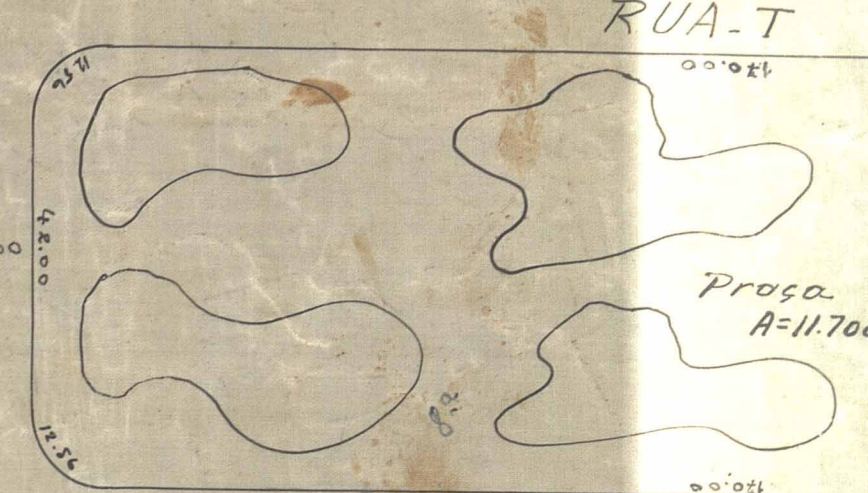
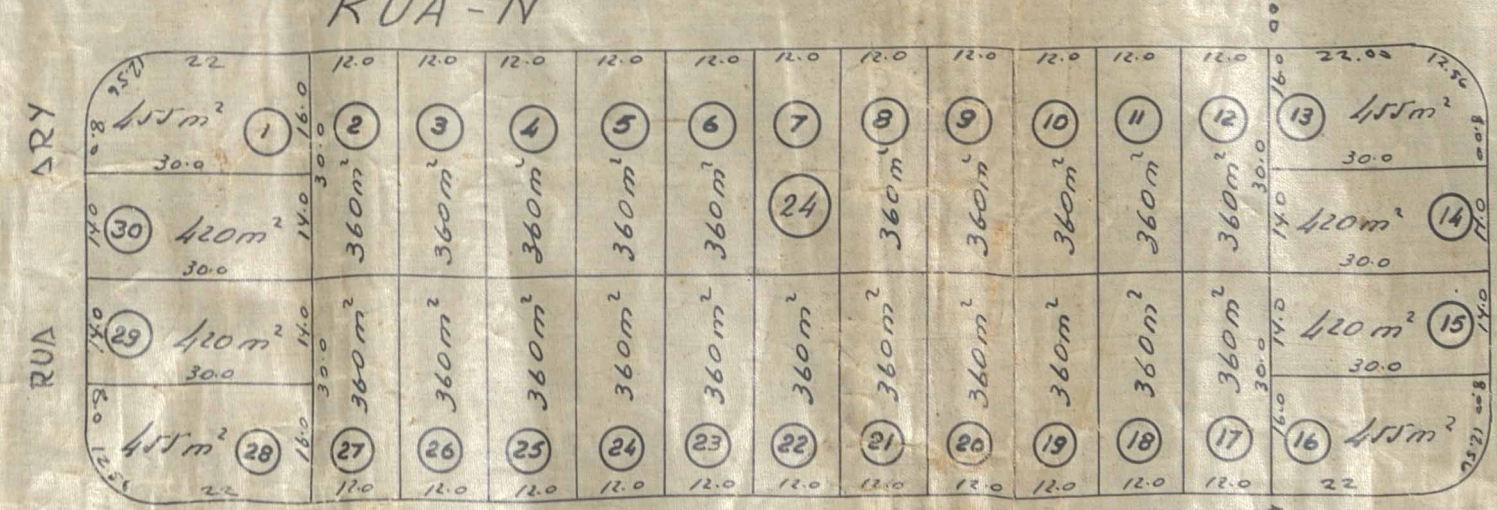
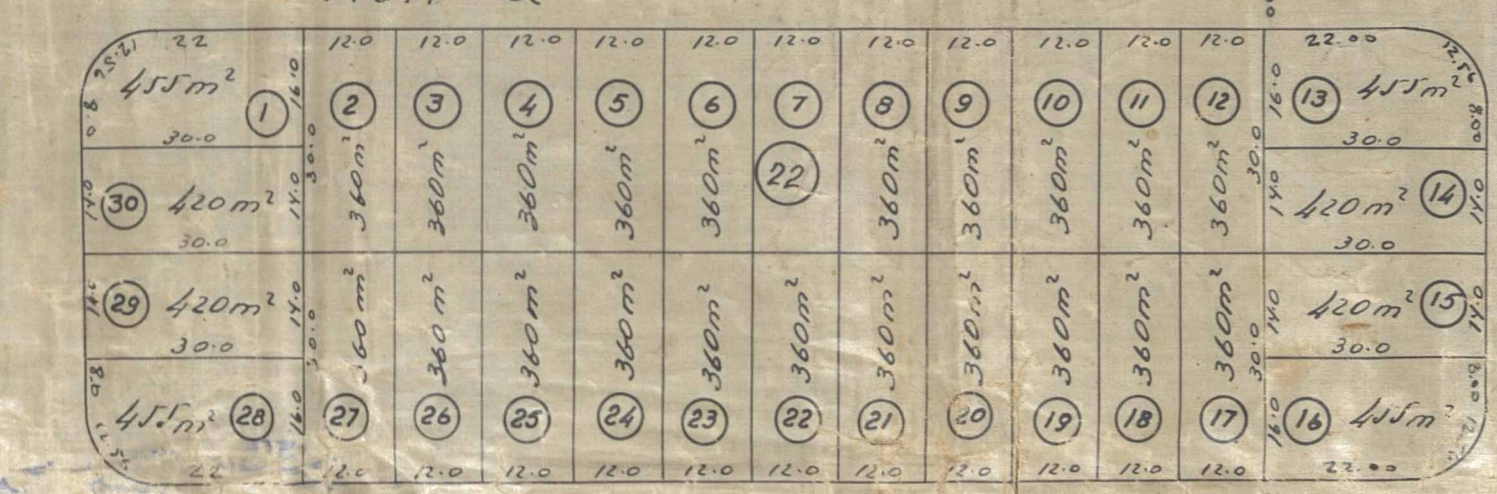
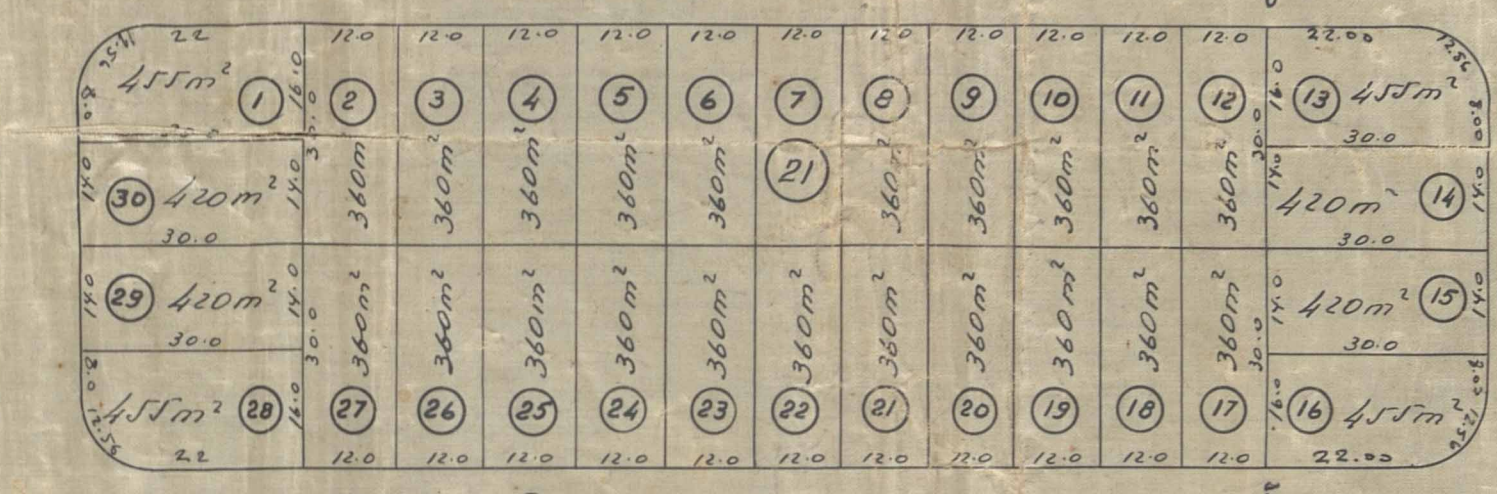
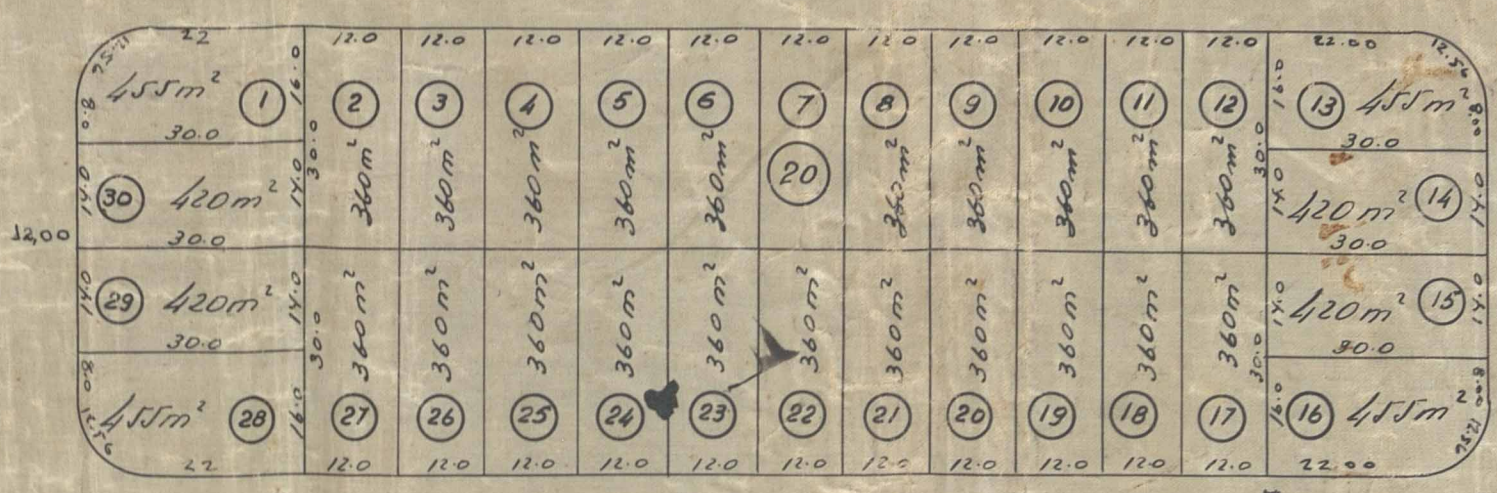
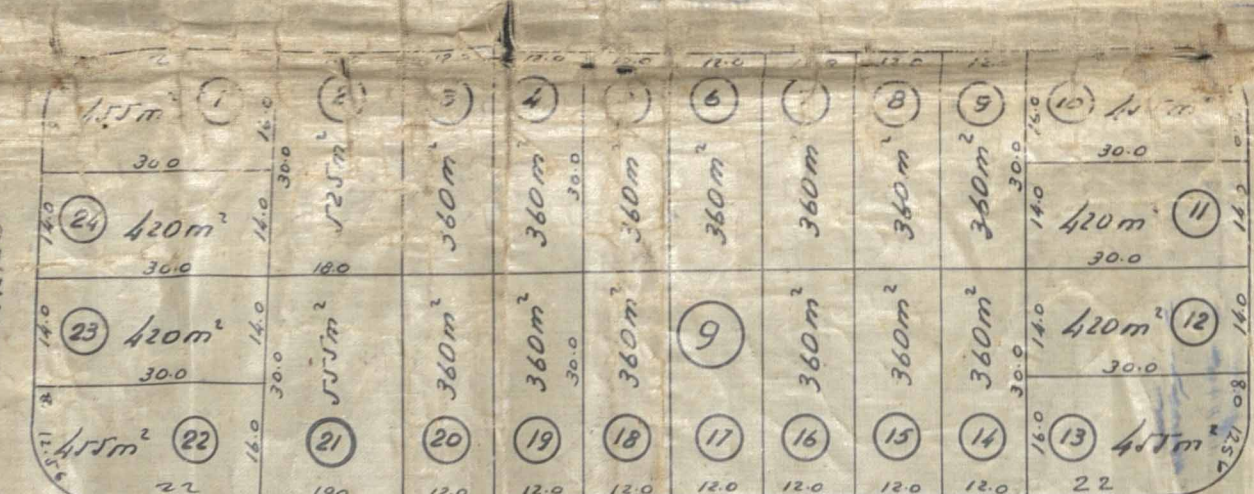
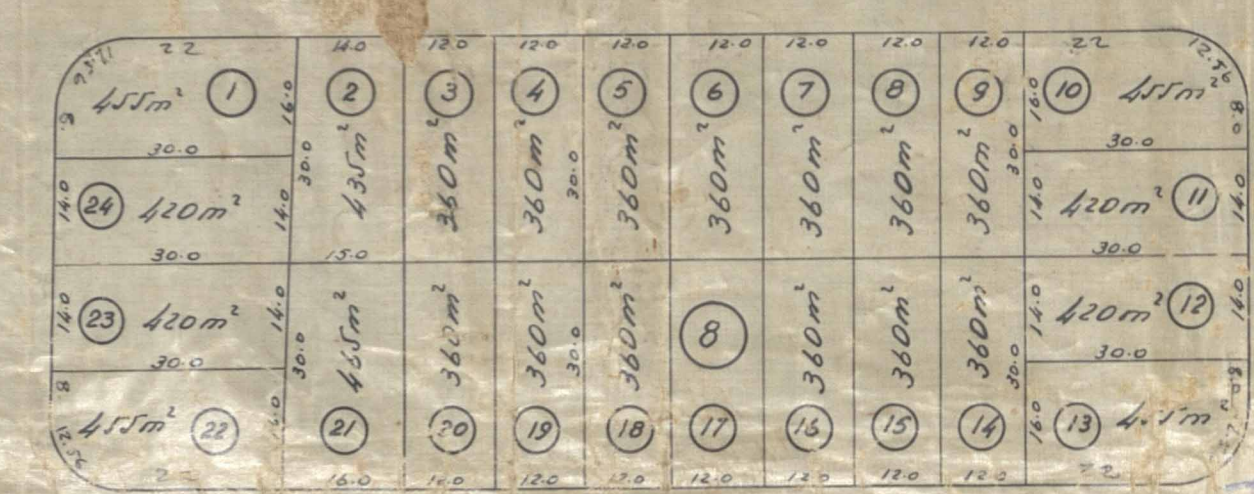
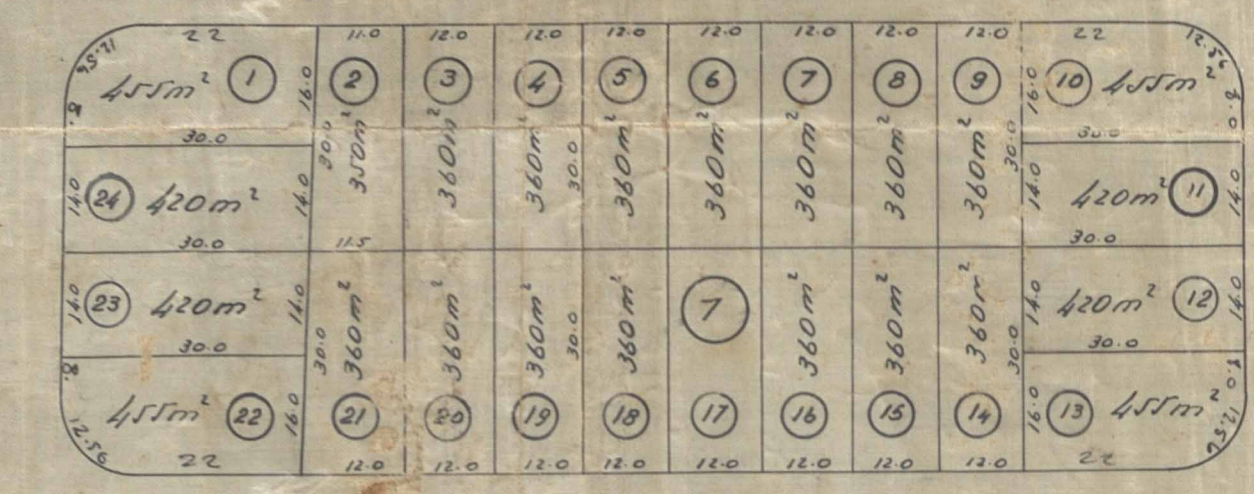
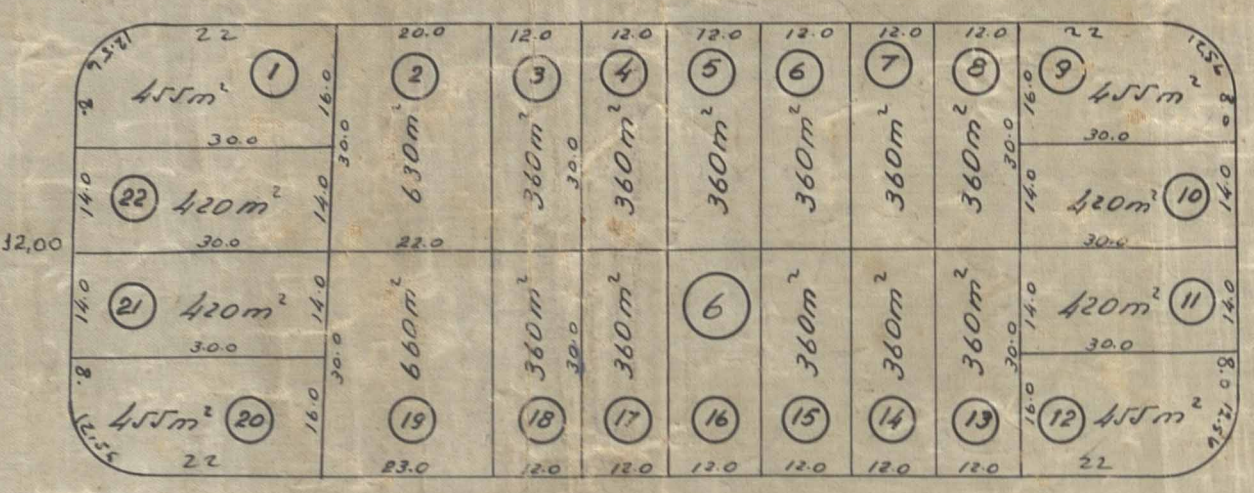
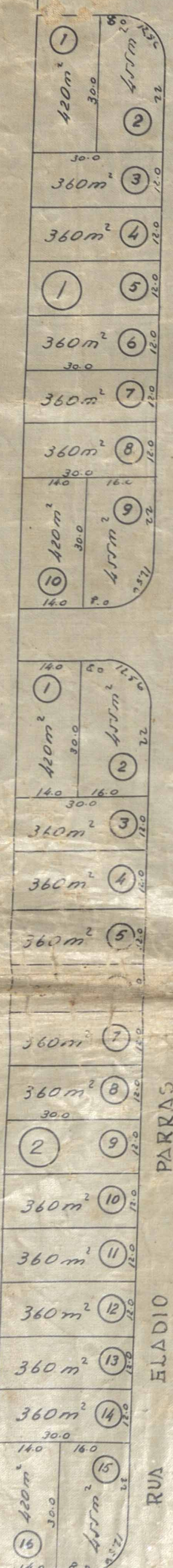

RUA M



Mapa de QUERQUILHAS

Ypiranga

RUA T



RUA S

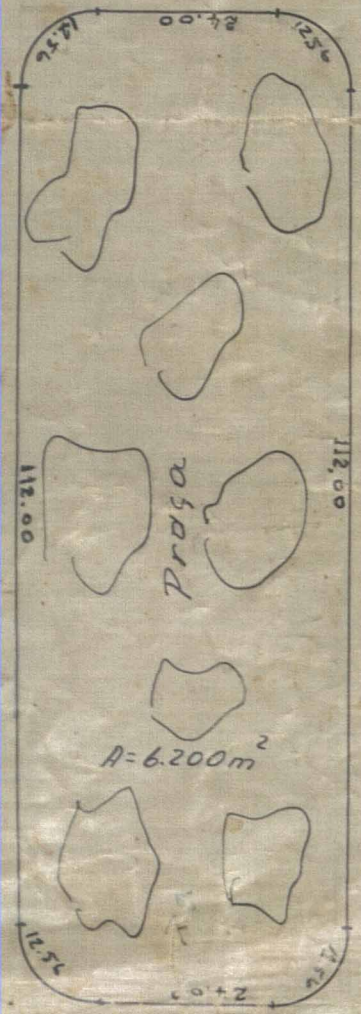

RUA P

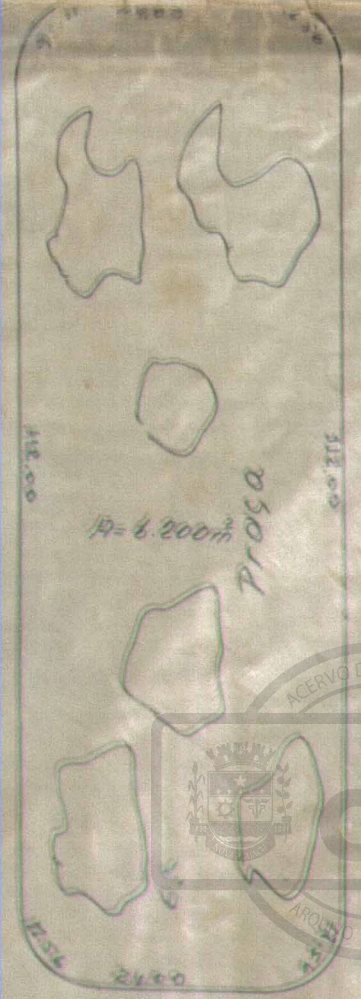

RUA M



RUA DIAS PAIVA



RUA CARLOTA WERNECK

RUA R

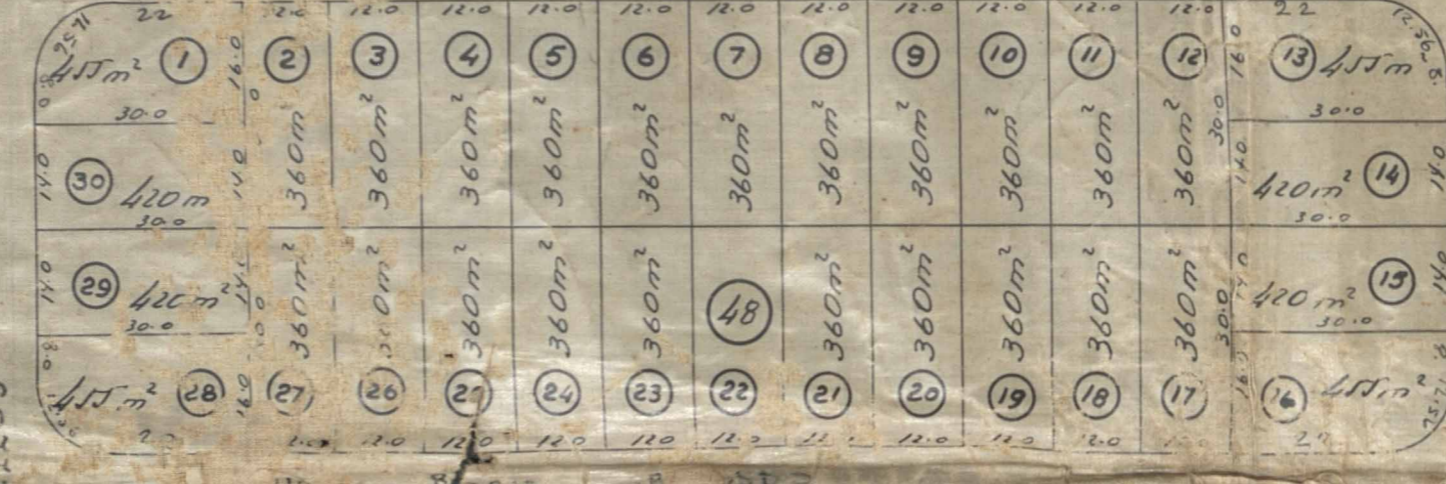

RUA MARIO RUDGE

RUA O



RUA NEY MENEZES

RUA CID QUADROS



RUA PEDRO DE ALBUQUERQUE

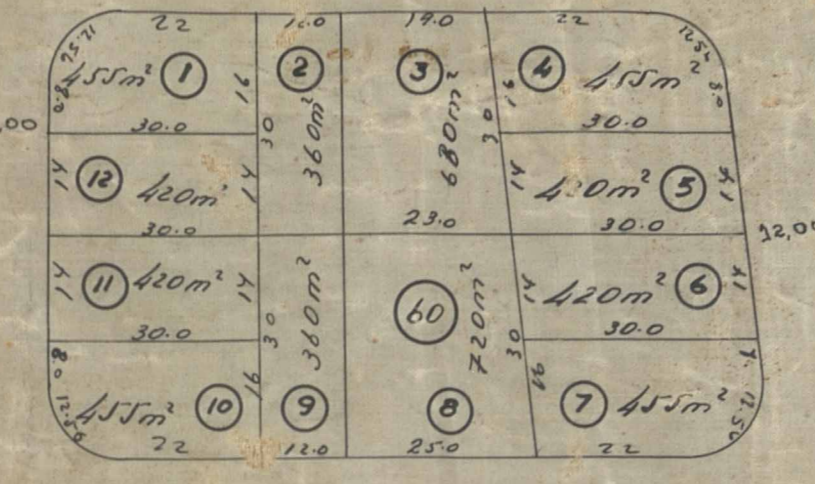

RUA SAMPAIO

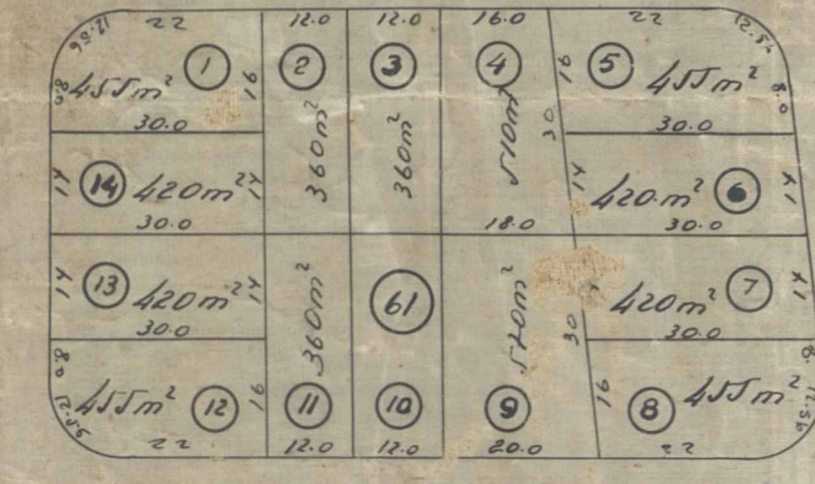

RUA MILTON VASCONCELLOS



RUA LUIZ DE VASCONCELLOS

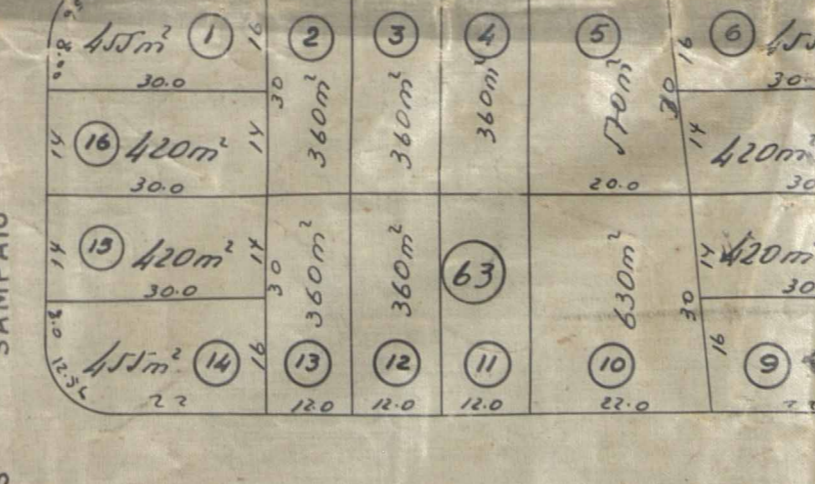

RUA PEDRO DE ALBUQUERQUE

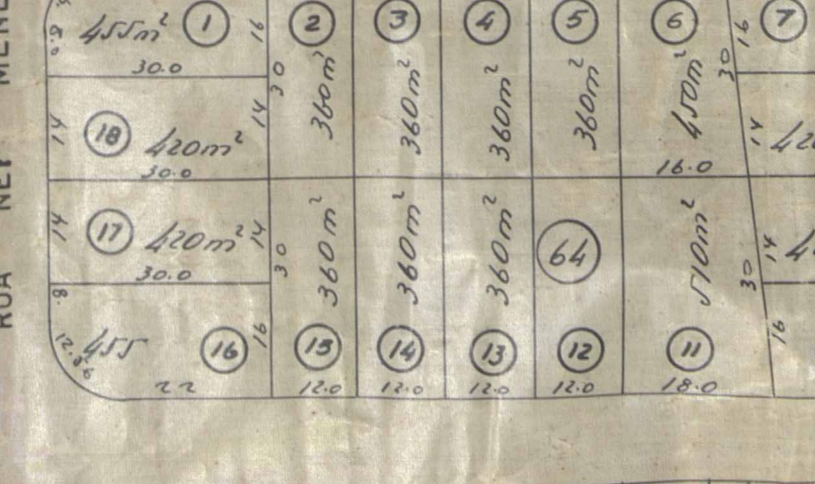

RUA PEDRO DE ALBUQUERQUE

PLANTA DE LOTEAMENTO  
SITUADA NA ESTRADA  
DE NOVA IGUAÇU  
ESCALA  
Nº de lotes 1.800  
Area da P.M.N.I (Praça)  
Nº de metros de rua  
Area total

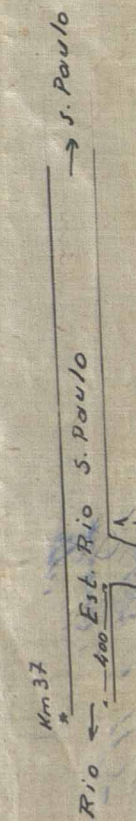



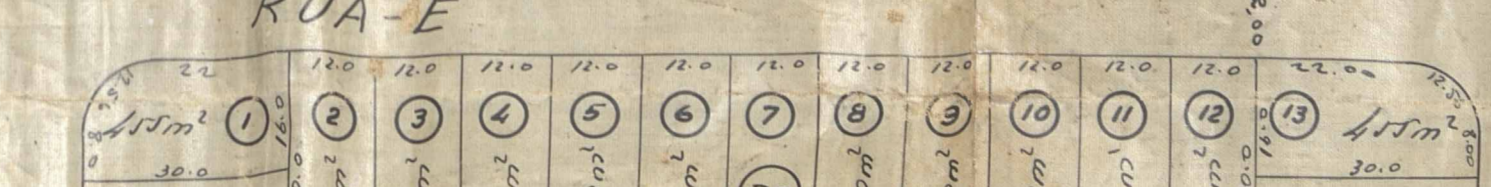
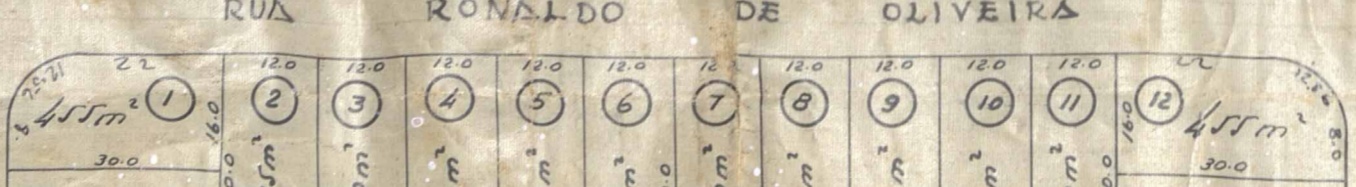
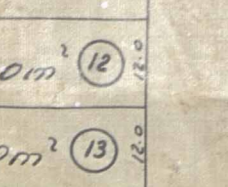
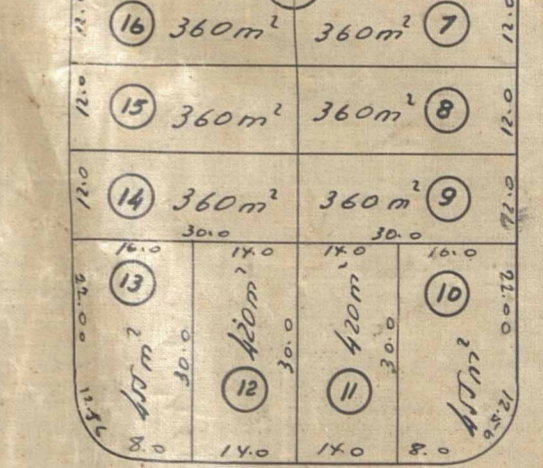
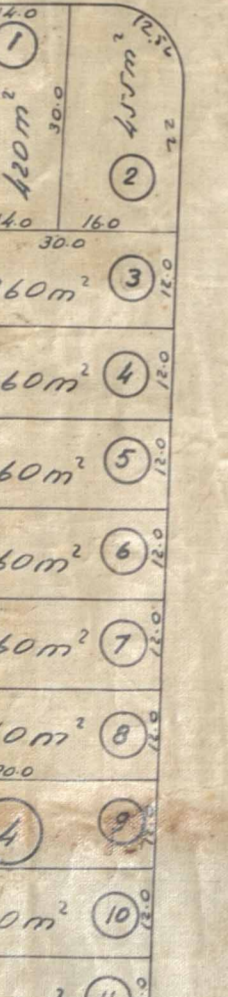
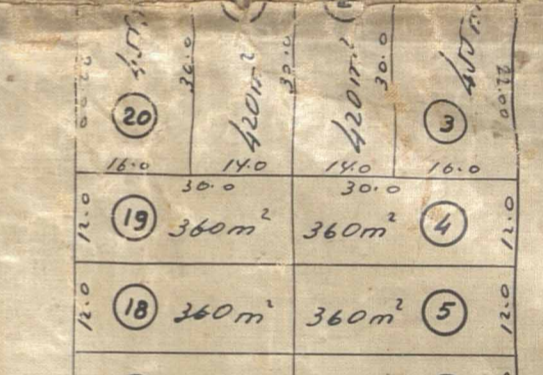
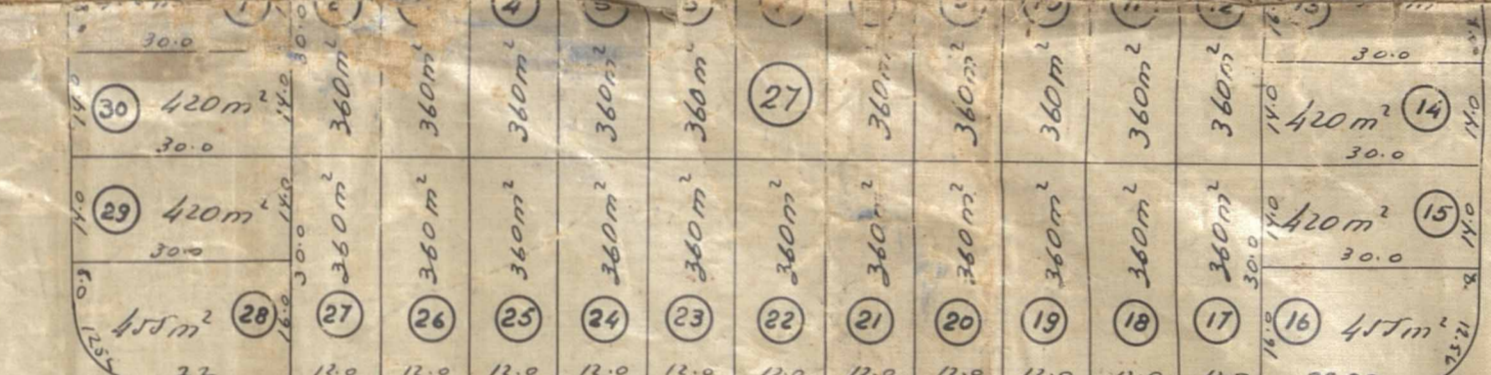
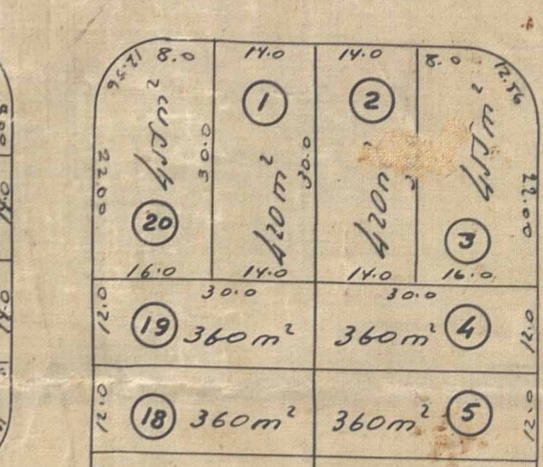
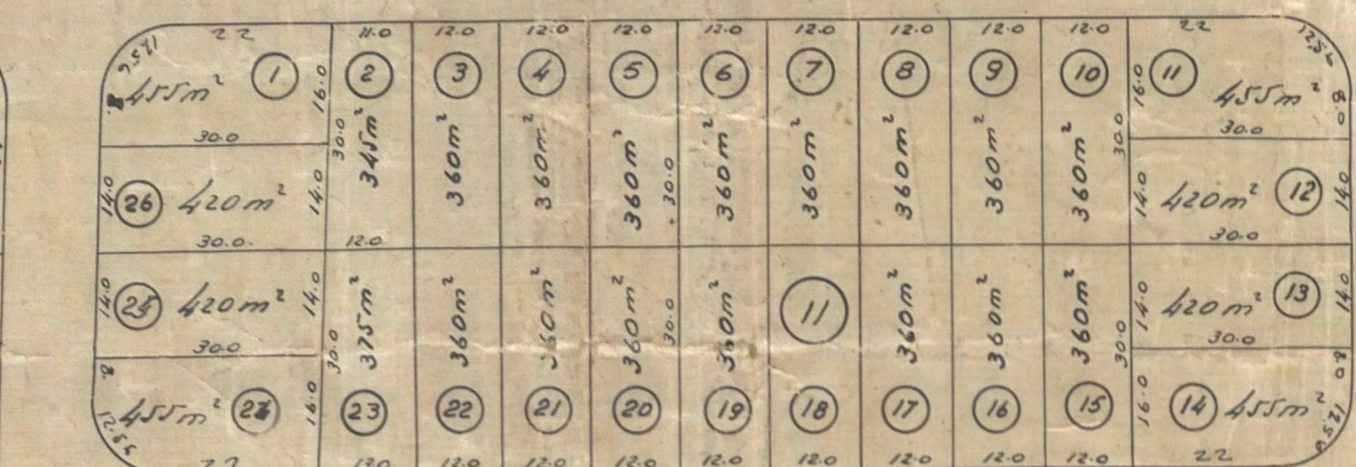
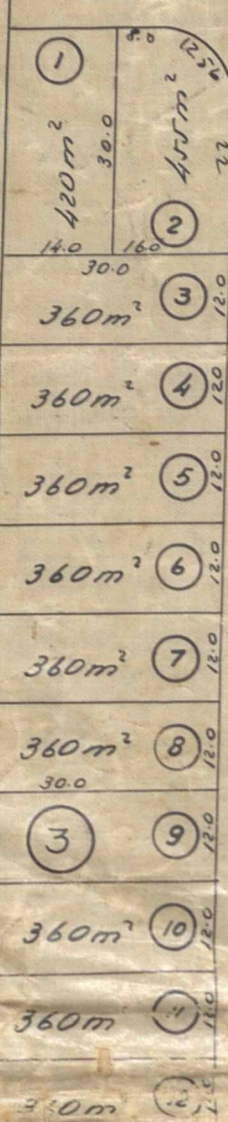
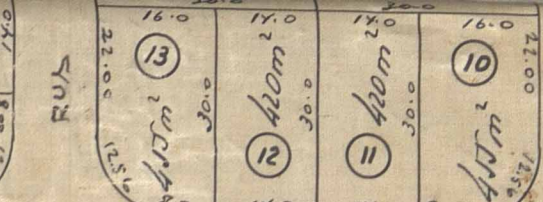
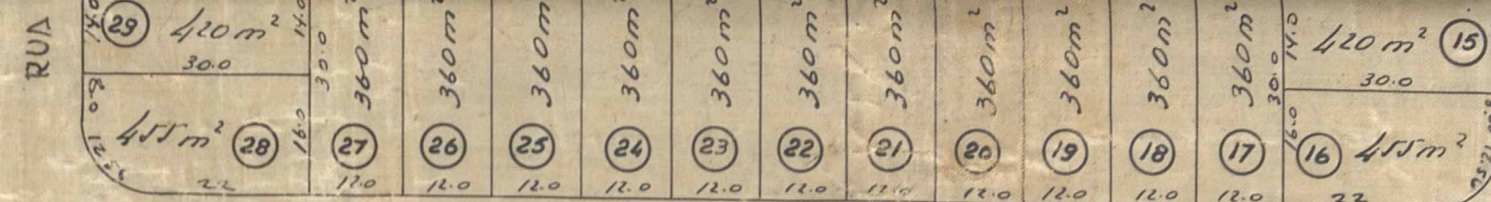
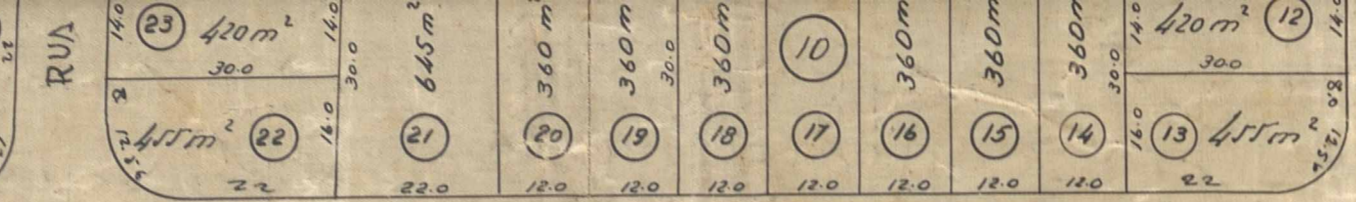







ORGANIZAÇÃO INDUSTRIAL CONTINENTAL LIMITADA

O Proprietario *João Montenegro*  
 O Engenheiro *Francisco Antonio de Castro*

ALBUQUERQUE DE



RUA-G

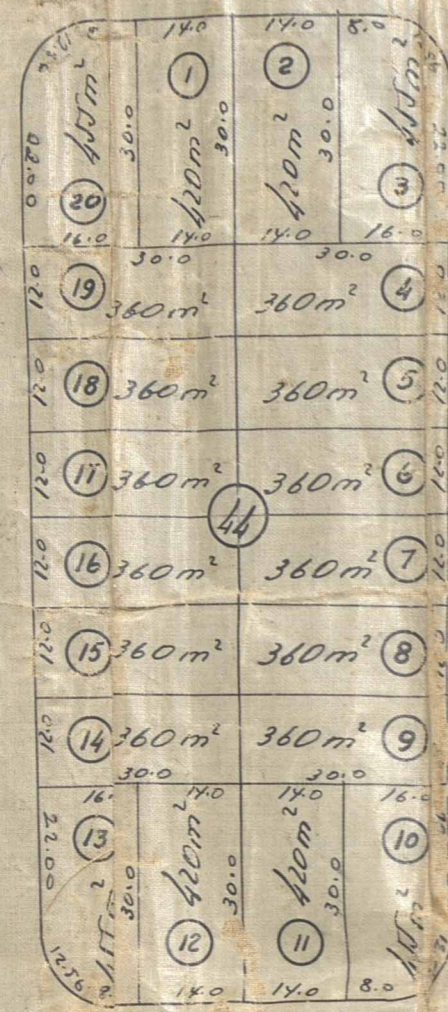
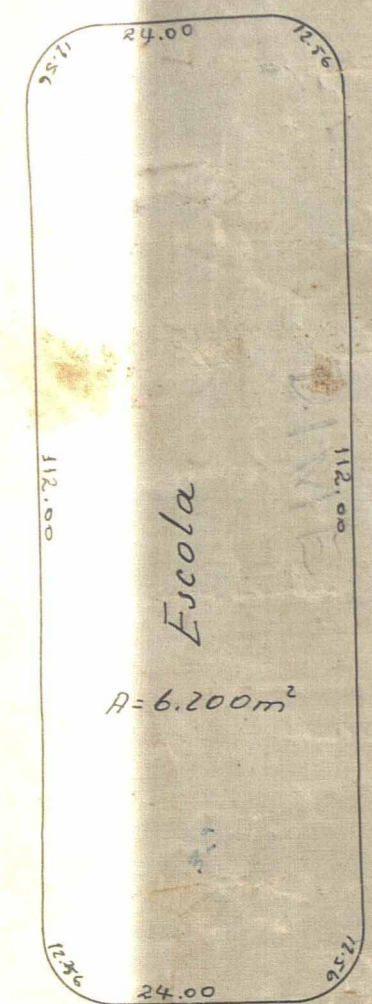

RUA CARLOS ALBERTO BARBOSA DE MIRANDA



RUA RAQUEL HAZEN RUA-F

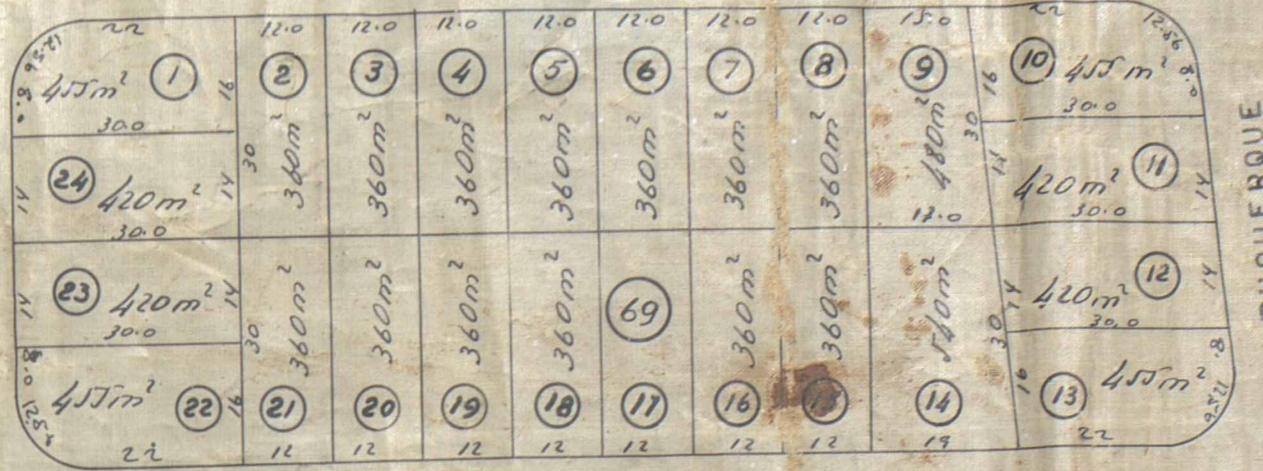
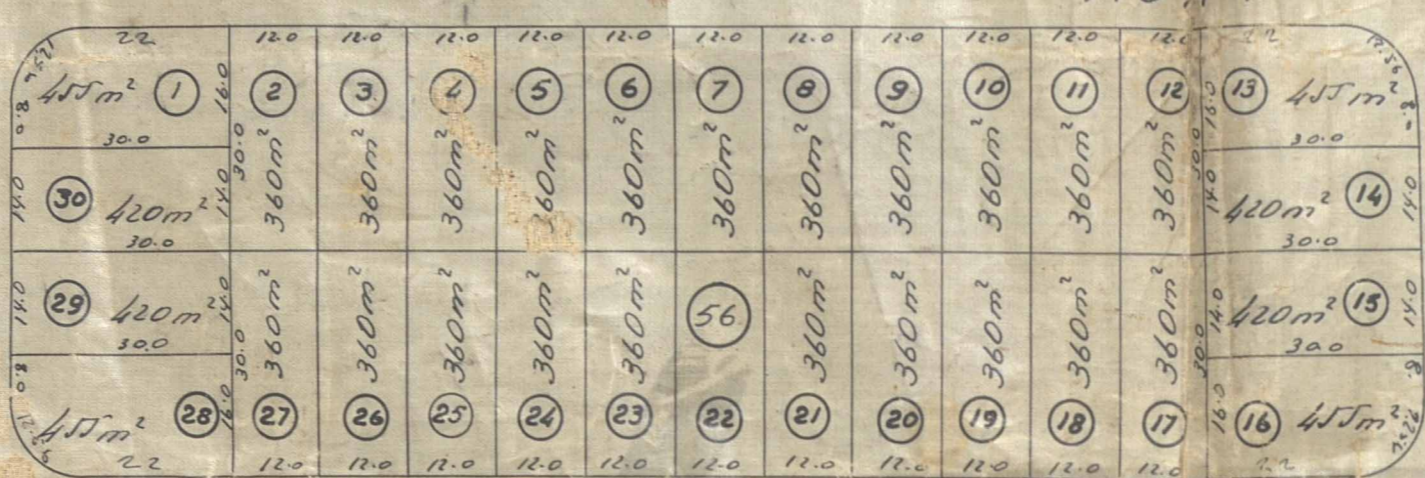

RUA HELCIO LEAL



RUA ROCHA SOUZA RUA-C



RUA FRANCISCO QUIDO

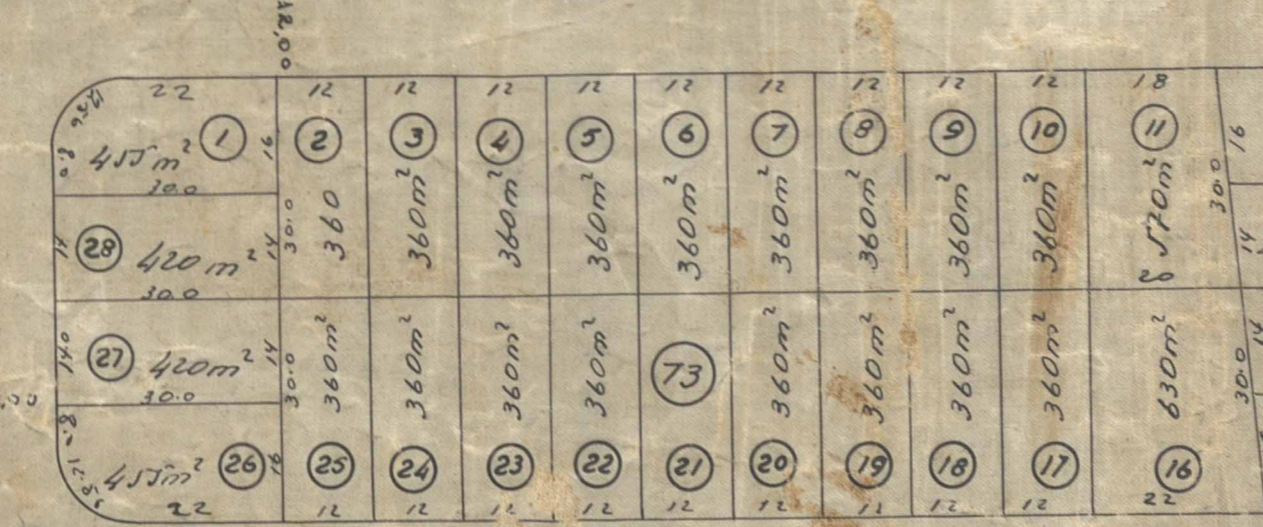
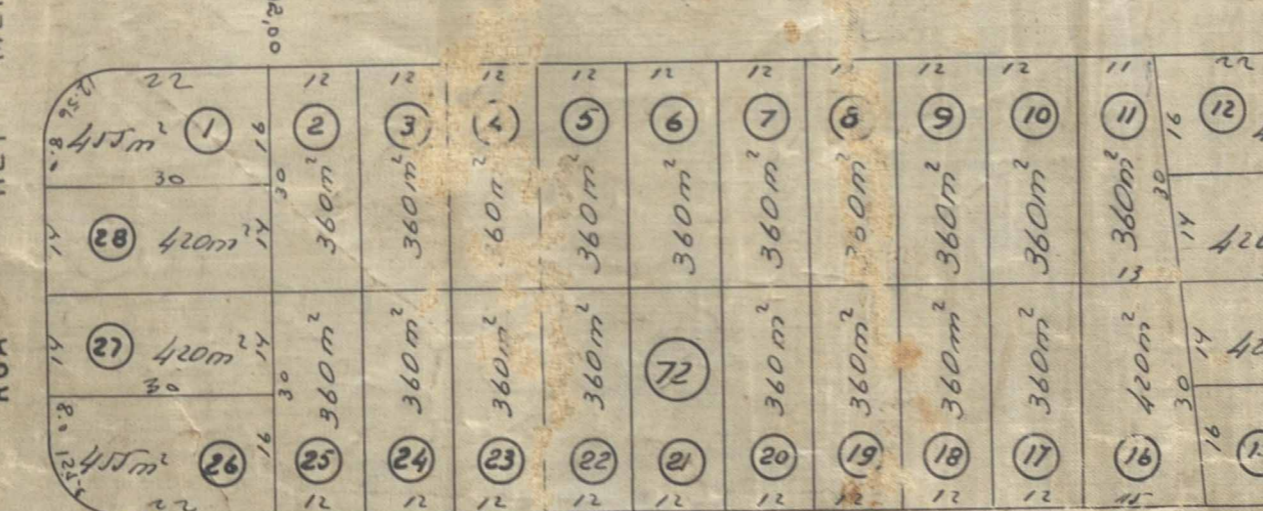
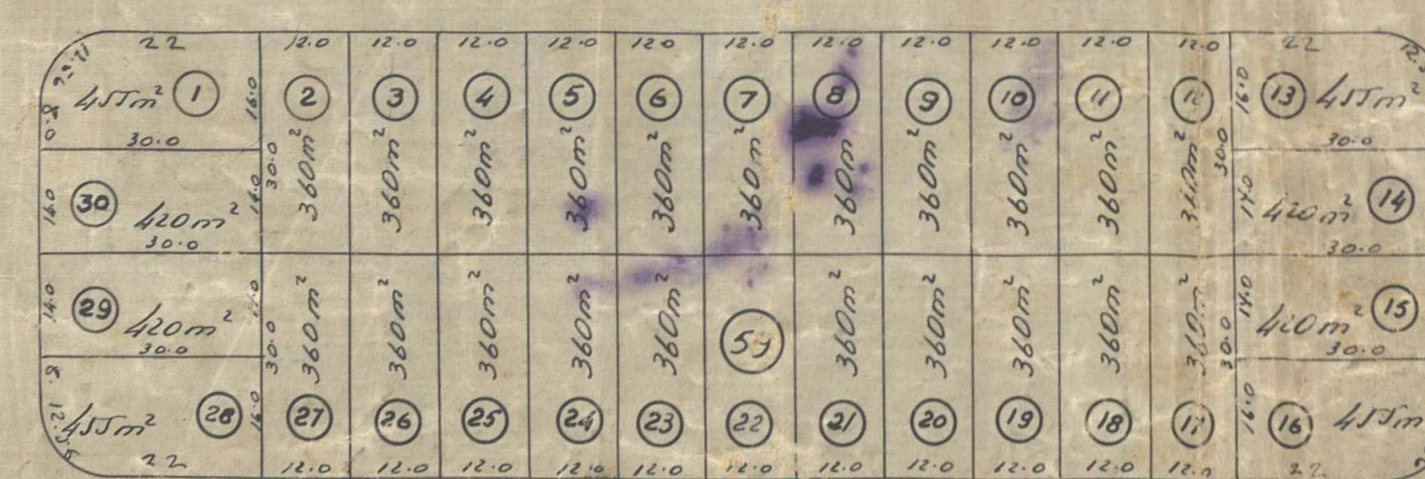

RUA-D

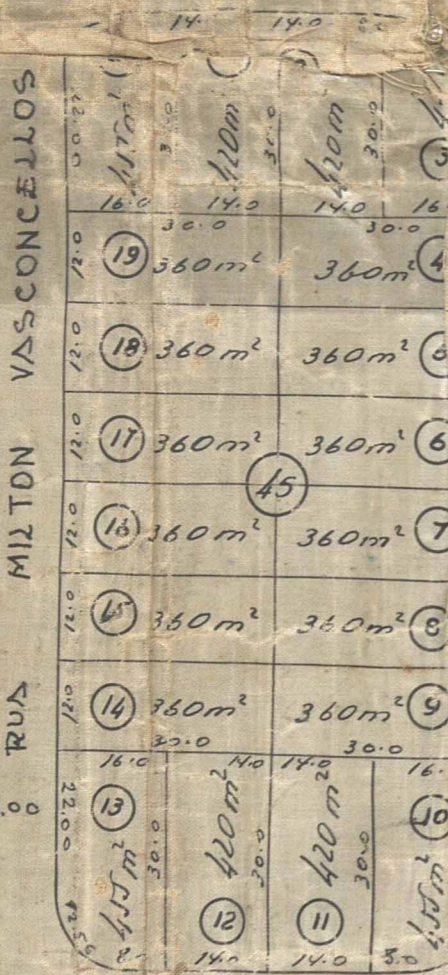
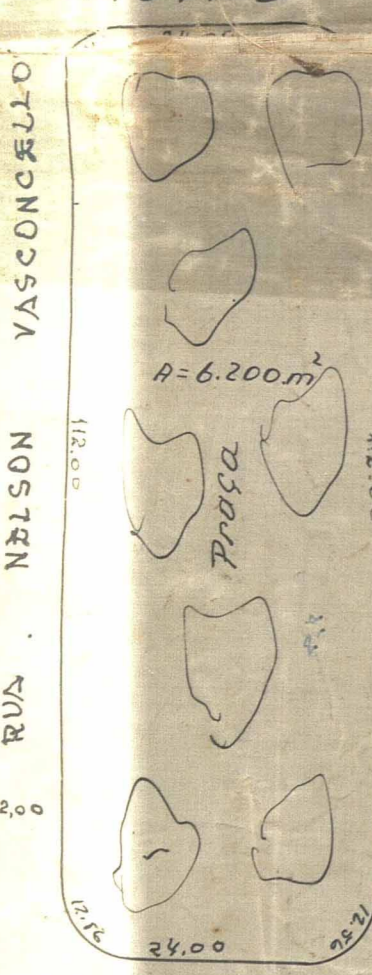

RUA-A

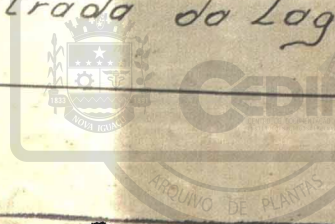
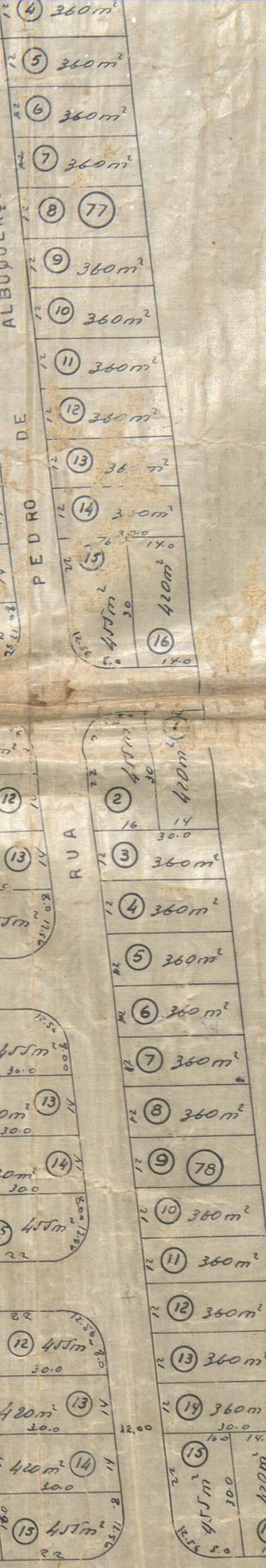
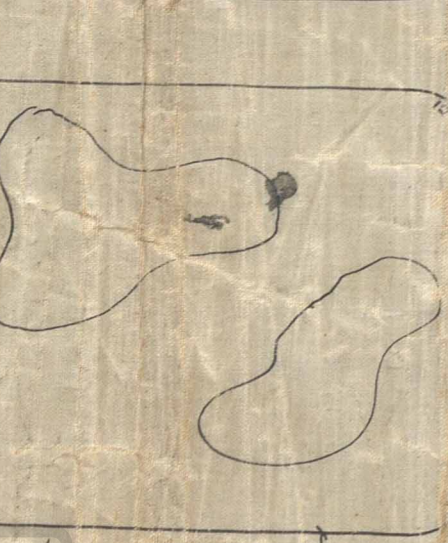
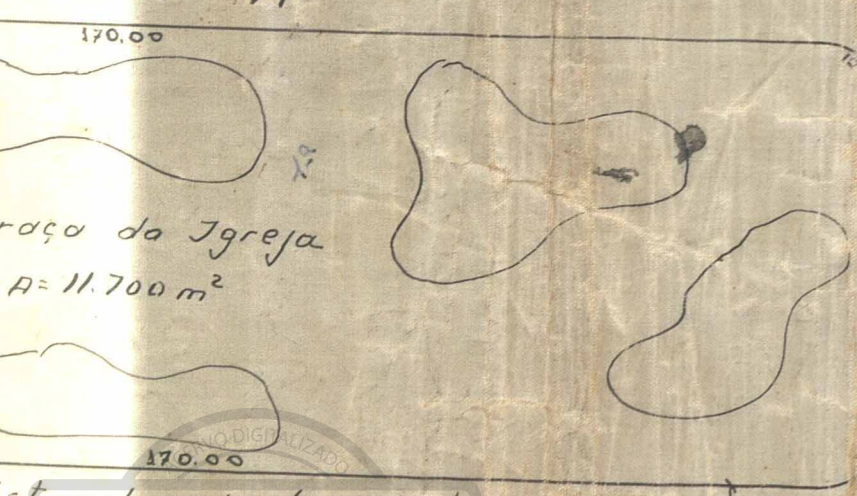



ACERVO DIGITALIZADO



**CEDIM**  
CENTRO DE DOCUMENTAÇÃO E IMAGEM  
INSTITUTO MULTIDISCIPLINAR - UFRRJ



ARQUIVO DE PLANTAS